

## Main installation principles

Due to properties of WPC it is necessary to keep a space at least 10 mm when connecting the boards as well as between the boards and the "F" profiles. Plank ends must be attached to the spars (mounting profiles). The recommended distance between the bars - 300 mm.

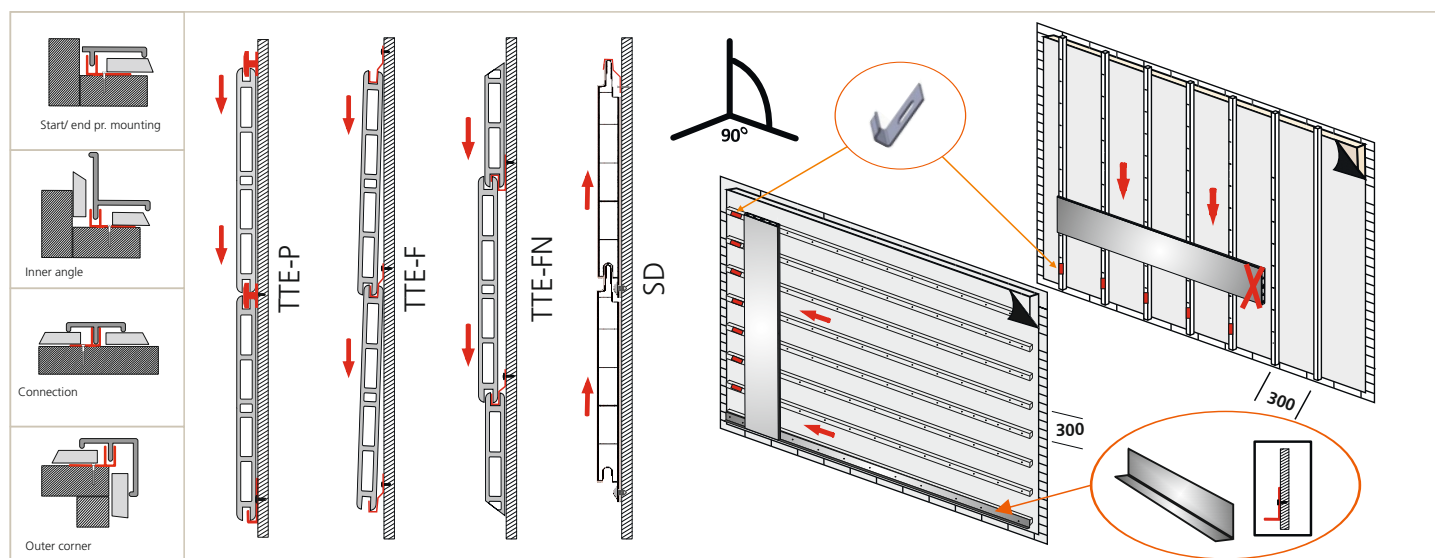

\* The customer is familiar to the information provided above.  
Any claims must be brought before mounting.



## Scheme for main installations principles

1. Wall; 2. Thermal and wind insulation; 3. Mounting bracket; 4. Guiding profile; 5. Mounting profile; 6. Primary L profile; 7. Start clip; 8. Mounting clips; 9. F profile; 10. Ground profile; 11. Outer angle profile; 12. Inner angle profile; 13. Start/end profile; 14. Connecting profile; 15. Cladding board.

### Vertical mounting

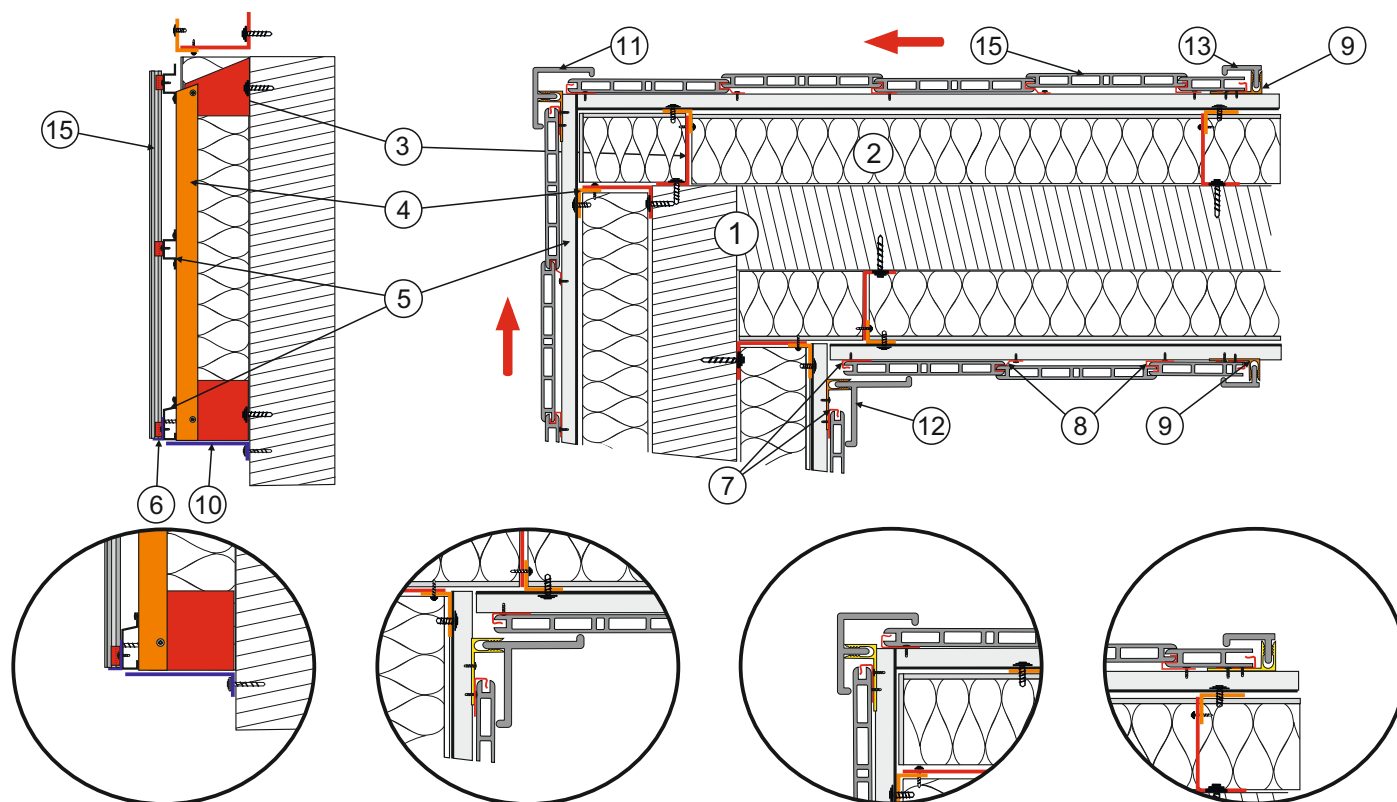

### Horizontal mounting

